



WAL CANOPY RANGEHOOD

INSTALLATION AND USER'S MANUAL

Model: TR 20160 & TR 20190

Contents

Introduction	2
Safety precautions	2
Installation	4
Installing the charcoal filter	8
Operation	9
Care and maintenance	10
Troubleshooting	11
Environmental protection	12

Introduction

Thank you for choosing this extractor hood.

To ensure that you get the best results from your new extractor, we strongly suggest that you read this instruction manual thoroughly before use. If treated with care, your extractor should give you years of trouble-free use

To register ownership, please ensure you complete and return the guarantee card supplied with the appliance.

This instruction manual is designed to provide you with all required information related to the installation, use and maintenance of the appliance.

These cooker hoods are designed to extract unpleasant odours from the kitchen; they are not intended to extract steam.

In order to operate the unit correctly and safety, please read this instruction manual carefully before installation and use.

The cooker hood uses high quality materials, and is made with a streamlined design. Equipped with an electric motor and centrifugal fan, it provides strong extraction with low noise. It also features non-stick grease filters and an easy installation.

Safety precautions

- Never let the children operate the machine.
- The cooker hood is for home use only, not suitable for barbecuing, restaurants or other commercial purposes.
- The cooker hood and its filter should be cleaned regularly in order to keep in good working condition.
- Clean the cooker hood according to the instruction manual to reduce the risk of fire.
- When using a gas hob, do not leave naked flames under the extractor.
- Before connecting this appliance check that the power supply cord is not

damaged. A damaged supply cord must be replaced by qualified service personnel only. Please contact the service department.

- If the room where the hood is to be used contains a fuel burning appliance such as a central heating boiler then its flue must be of the sealed or balanced flue type. If other types of flue or appliances are fitted ensure that there is an adequate supply of air to the room.
- The air must not be discharged into a flue that is used for exhausting fumes from appliances burning gas or other fuels.
- Regulations concerning the discharge of air have to be conformed to.
- This appliance if not intended for use by persons (including children) with reduced physical, sensory or mental capabilities, or lack of experience and knowledge, unless they have been given supervision or instruction concerning use of the appliance by a persons slide for their safety.
- Children should be supervised to ensure that they do not play with the appliance.
- Do not flambé under the cooker hood.
- Never leave frying pans unattended during use as over-heated fats and oils may catch fire.
- To ensure the best performance, we recommend switching on the extractor 15 minutes before cooking and leave it running 15 minutes after. This will ensure that the air in the kitchen is being circulated before cooking commences and the air is being cleaned after cooking has finished.
- The performance of your extractor will vary depending on a number of factors. These include type of extraction, room volume, length of ducting, ventilation available and the cleanliness of the filters.

Electrical shock hazard

- Only plug this unit into a properly earthed outlet. If in doubt seek advice from a suitably qualified engineer.
- Failure to follow these instructions can result in death, fire, or electrical shock.

Installation

Prepare for the installation:

- a. If you have an outlet to the outside, your cooker hood can be connected as per the below picture by means of an extraction duct with an interior diameter of 150mm.

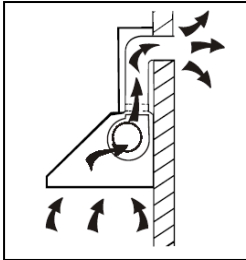

- b. Before installation, turn the unit off and unplug it from the outlet.

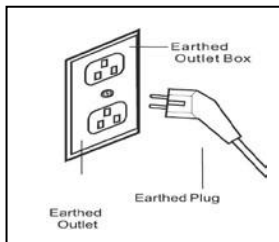

- c. The cooker hood should be placed at a minimum distance of 65~76cm above the hob. It is the manufacturer of the hob who determines the clearance required and the clearance quoted by the hob manufacturer must be followed. In the absence of any instructions supplied with a gas hob the minimum distance between the hob and the hood must be

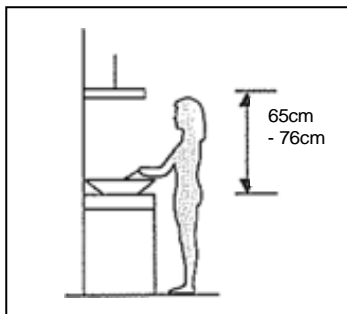

at least 760mm.

Installation – ducted

Attention! Observe the warning concerning the operation of the appliance when air is discharged from the room.

Drill 3 x 8mm holes to accommodate the bracket. Screw and tighten the bracket onto the wall with the screws and screw plugs provided.

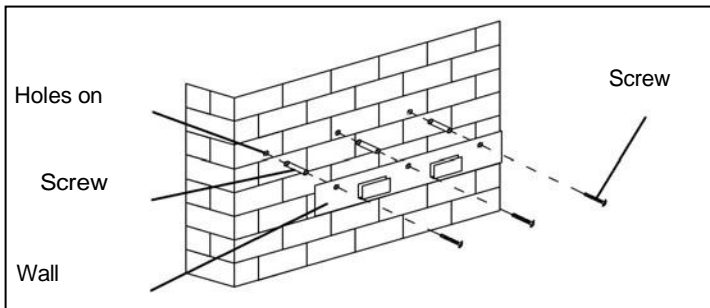

Lift up the cooker hood and hang it onto the wall bracket hooks.

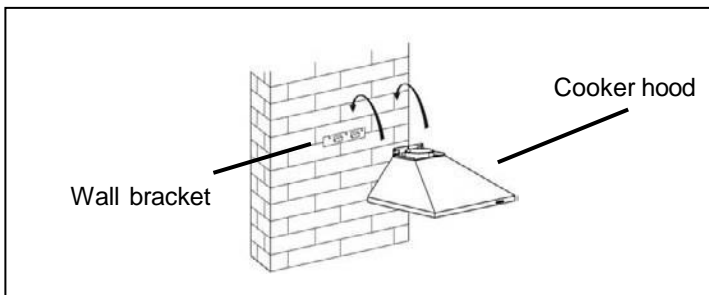

After hanging the hood on the bracket , remove the Alu Filters , mark 2 holes inside the hood for safety screws .After marking , remove the hood ,drill two holes and insert 2 pcs of Wall Plugs and finally fix the safety screws with 2 screws ST4x30mm

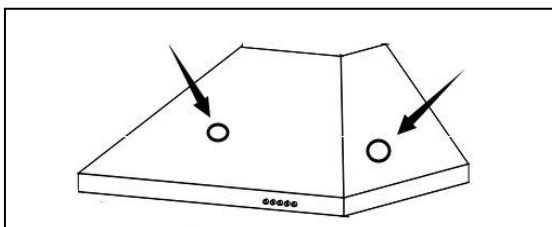

Fix the one-way-valve to the air outlet of the cooker hood. Then, attach the exhaust pipe to the one-way-valve as shown below.

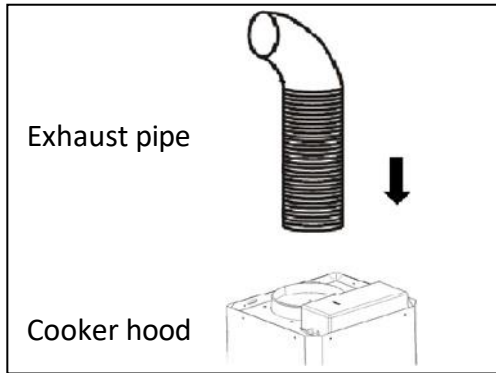

Chimney installation.

Place the upper chimney into the lower chimney .

Use 2 pcs ST4x8mm screws to attach lower and upper chimney together. Before attaching the bracket to the chimney,decide the location of lower chimney bracket fixing holes for fixing the lower chimney bracket in the later steps.

Do not fasten screws too much, make sure upper chimney can be telescopically adjusted after assembled.

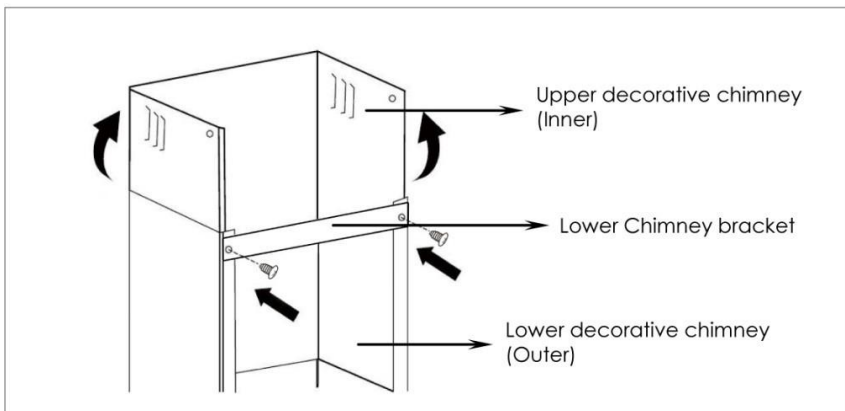

Drill 2 holes to accommodate the plate II. Screw and tighten the plate II onto the wall with two screws and wall.plugs provided Slide up the upper chimney and fix the upper chimney with plate II with 2 screws ST4x8mm

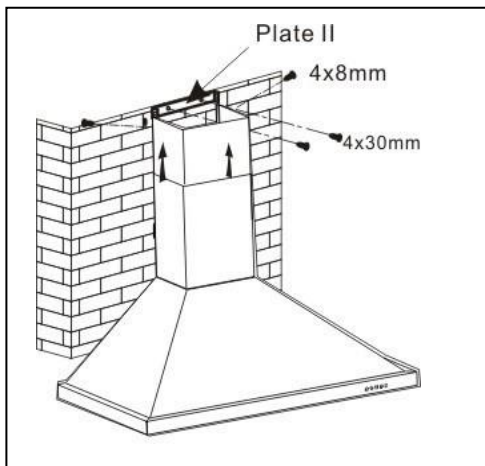

Fix the lower chimney with the hood with 2 screws ST4x8mm

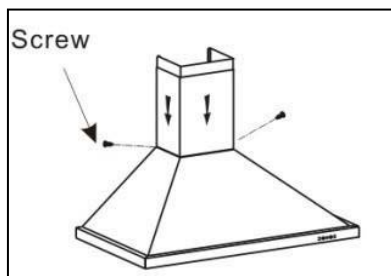

Installation – recirculation mode

If you do not have an outlet to the outside, the exhaust pipe is not required (as shown in the section “Installation - ducted”).

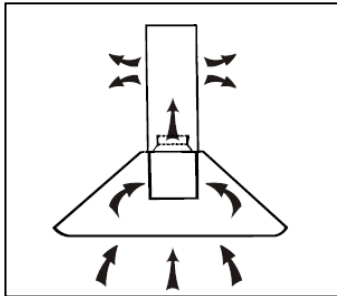

Installing the charcoal filter

An activated charcoal filter can be used to trap odours. In order to install the charcoal filter, the grease filter should be detached first. Press the lock and pull it downward.

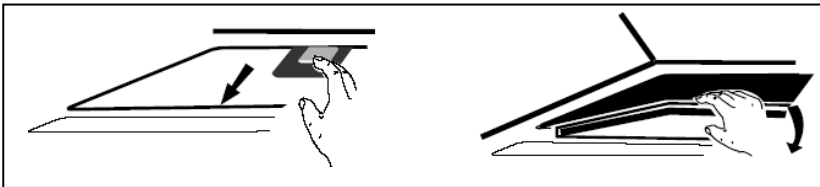

Fit the activated charcoal filter onto the side of the motor and turn it in a clockwise direction. Repeat the same on the other side.

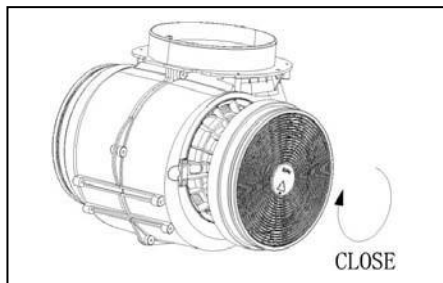





NOTE:

- Make sure the filter is securely locked in position. Otherwise, it may loosen and become dangerous.
- When the charcoal filter is attached, the extraction power may be slightly reduced.

Operation



-  Low speed button
Is suitable for simmering and cooking which does not produce much odour.
-  Medium speed button
The airflow speed is ideal for extracting with regular cooking.
-  High speed button
When a high amount of smoke or odour is produced, press the high speed button for the most effective extraction.
-  Light button
This switches the light on and off

NOTE: If the low, medium and high speed buttons are pressed at the same time, the unit will only operate at the highest speed.

Care and maintenance

IMPORTANT: Before cleaning or maintenance please switch off the electricity supply and remove the plug from the wall.

Regular cleaning

Use a soft cloth moistened with lukewarm mildly soapy water or household cleaning detergent. Never use metal pads, chemicals, abrasive material, abrasive cleaning creams or stiff brushes to clean the appliance.

Cleaning the grease filter

Clean the filter every month to help minimise the risk of fire.

The filter collects grease, smoke and dust, therefore the filter is directly affecting the efficiency of the cooker hood. If not cleaned, the grease residue (which is potentially flammable) will saturate the filter. It can be easily cleaned with warm water and washing up liquid, alternatively the filters can be cleaned in your dishwasher. Please ensure no other items are washed with the filters, they must be washed separately to prevent food becoming trapped in the gauze. Cleaning the grease filters in the dishwasher may lead to discolouration, this is normal and is not a fault with the product.

Replacing your charcoal filter

This only applies if you are using the hood in recirculation mode (not vented to the outside). The charcoal filter traps your cooking odours and they need to be replaced, this can vary depending on how frequently the cooker hood is used. We recommend replacing them at least every 6 months.

Replacing the bulb

1. Switch the unit off and unplug the appliance.
2. Remove the lamp cover by unscrewing the 2 screws.
3. Unscrew the bulbs.
4. Replace with the same type and rated bulb/lamp.

Troubleshooting

Fault	Cause	Solution
The lights on, but the fan does not work	The fan blade is jammed.	Switch off the unit and repaired by qualified service personnel only.
	The motor is damaged.	
The lights and fan do not work	A blown fuse	Replace the fuse
	The power cord is loose.	Plug in to the power supply again.
Serious vibration of the unit	The fan blade is damaged.	Switch off the unit and repaired by qualified service personnel only.
	The fan motor is not fixed tightly.	Switch off the unit and repaired by qualified service personnel only.
	The unit is not hung correctly on the bracket.	Take down the unit and check whether the bracket is in the correct location.
The extraction performance is not good	The filter requires cleaning	Clean the grease filter as directed in the 'Care and maintenance' section. Replace the charcoal filter (if in recirculation mode)

Environmental protection

Waste electrical products should not be disposed of with household waste. Please recycle where facilities exist. Check with your Local Authority or retailer for recycling advice.



This appliance is marked according to the European directive 2012/19/EC on Waste Electrical and Electronic Equipment (WEEE).

By ensuring this product is disposed of correctly, you will help prevent potential negative consequences for the environment and human health, which could otherwise be caused by inappropriate waste handling of this product.

The symbol on the product indicates that this product may not be treated as household waste. Instead it shall be handed over to the applicable collection point for the recycling of electrical and electronic equipment.

Disposal must be carried out in accordance with local environmental regulations for waste disposal.

For more detailed information about treatment, recovery and recycling of this product, please contact your local council, your household waste disposal service or the retailer where you purchased the product.

